

101 0330
L

TOWN AND COUNTRY PLANNING (GENERAL PERMITTED DEVELOPMENT) ORDER
1995

DIRECTION MADE UNDER ARTICLE 4(1) TO WHICH ARTICLE 5(4) APPLIES

WHEREAS The Council of St Albans City and District being the appropriate local planning authority within the meaning of Article 4(6) of the Town and Country Planning (General Permitted Development) Order 1995, are satisfied that it is expedient that development of the description set out in the Schedule below should not be carried out on land at the rear of Lower Luton Road, Wheathampsted, as shown hatched blue on the attached plan, unless permission is granted on an application made under Part III of the Town and Country Planning Act 1990.

AND WHEREAS the Council consider that development of the said description would be prejudicial to the proper planning of their area and would constitute a threat to the amenities of their area and that the provisions of paragraph 4 of the Article 5 of the Town and Country Planning (General Permitted Development) Order 1995 apply,

NOW THEREFORE the said Council in pursuance of the power conferred on them by Article 4(1) of the Town and Country Planning (General Permitted Development) Order 1995 hereby direct that the permission granted by Article 3 of the said Order shall not apply to development on the said land of the description set out in the Schedule below.

THIS DIRECTION is made under Article 4(1) of the said Order and, in accordance with Article 5(4), shall remain in force until 8th January 2005 and shall then expire unless it has been approved by the First Secretary of State.

SCHEDULE

Development of the following parts and classes as described in Schedule 2 of the Town and Country Planning (General Permitted Development) Order 1995.

Part 2: Minor Operations

Class A: The erection, construction, maintenance, improvement or alteration of a gate, fence, wall or other means of enclosure

GIVEN UNDER THE COMMON SEAL
OF THE CITY AND DISTRICT
COUNCIL OF ST ALBANS ON
THIS 9th DAY OF JULY 2004

THE COMMON SEAL OF THE COUNCIL
WAS HERETO AFFIXED IN THE
PRESENCE OF:-

MAYOR

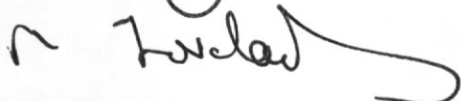

HEAD OF PAID SERVICE

AUTHORIZED OFFICER



THE COMMON SEAL of THE COUNCIL

of the DISTRICT OF ST ALBANS was

hereunto affixed in the presence

of:-

[Signature]
3100
3100

Mayor

[Signature]

Authorised Officer

THE SITE

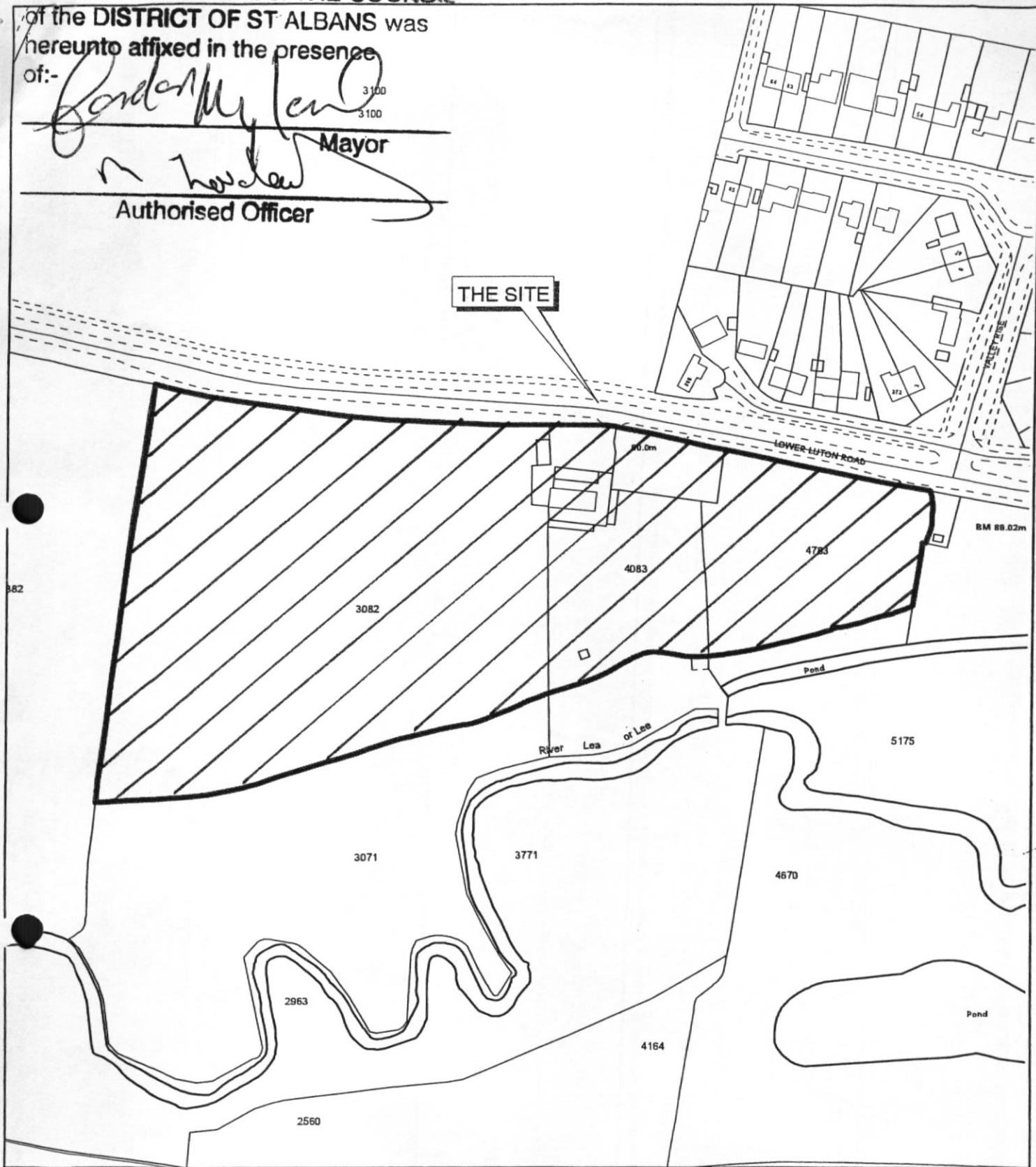

0 30 60 90 120 150 180 210 240 270 300 Meters



Land at Lower Luton Road, Wheathampstead

SCALE: 1:2000

DRAWN BY: JCM

Notes:

REF:



St Albans
CITY AND DISTRICT

Reproduced from the Ordnance Survey map
with the permission of the Controller of
Her Majesty's Stationery Office.

Crown Copyright

Unauthorised reproduction infringes Crown
Copyright and may lead to prosecution or
civil proceedings. Licence No. LA 079227