

This plan must be used with the attached 'Symbols' document.

Date Requested: 23/07/2021
 Job Reference: 22778282
 Site Location: 512403 204375
 Requested by:
 Mrs Amy Bedford
 Your Scheme/Reference: 26728
 Scale: 1:3075 (When plotted at A4)

Reproduced by permission of Ordnance Survey on behalf of HMSO. © Crown copyright and database right, 2020. All rights reserved. Ordnance Survey Licence numbers 100019626, 100019626 and 100019450. Data has been added to the Ordnance Survey base map. All proprietary rights in such additional data are and shall remain the exclusive property of © London Power Networks plc or Eastern Power Networks plc or South Eastern Power Networks plc each being a distribution licensee under section 6(1)(c) of the Electricity Act 1989 for the relevant distribution services area as that term is defined in such licensee's distribution licence. All rights in such data reserved.

Plans generated by digSAFE Pro™ software provided by Linesearchor@bt.com

Dig Sites Area: **Line:**

The quality and accuracy of any print will depend on your printer, your computer and its print settings. Measurements scaled from this plan may not match measurements between the same points on the ground.

1. UK Power Networks does not warrant that the information provided to you is correct. You rely upon it at your own risk. UK Power Networks does not exclude or limit its liability if it causes the death of any person or causes personal injury to a person.

2. UK Power Networks does not accept any liability for any loss, damage, cost, claim, demands, or expenses that you or any third party may suffer or incur as a result of using the information provided whether for physical damage to property or for any economic loss of any kind, including but not limited to, loss of savings, loss of goodwill, loss of business, loss of use or any special or consequential loss or damage whatsoever.

3. This plan has been provided to you on the basis of the terms of the licence set out in the covering letter that accompanies this plan and must be returned to the sender of this letter.

4. This plan is provided to you on the basis of the information provided to you. It must not be given, sold or made available to any third party. UK Power Networks electricity network and should not be used for any other purpose.

5. Please Note: This Overview map does not display UK Power Networks electricity network and should not be used for excavation or other ground works. For details of the electricity network, please refer the relevant page or pages highlighted in the Overview map.

6. Please Note: The Overview map does not display UK Power Networks electricity network and should not be used for excavation or other ground works. For details of the electricity network, please refer the relevant page or pages highlighted in the Overview map.

7. UK Power Networks does not warrant that the information provided to you is correct. You rely upon it at your own risk. UK Power Networks does not exclude or limit its liability if it causes the death of any person or causes personal injury to a person.

8. UK Power Networks does not accept any liability for any loss, damage, cost, claim, demands, or expenses that you or any third party may suffer or incur as a result of using the information provided whether for physical damage to property or for any economic loss of any kind, including but not limited to, loss of savings, loss of goodwill, loss of business, loss of use or any special or consequential loss or damage whatsoever.

9. This plan has been provided to you on the basis of the terms of the licence set out in the covering letter that accompanies this plan and must be returned to the sender of this letter.

10. This plan is provided to you on the basis of the information provided to you. It must not be given, sold or made available to any third party. UK Power Networks electricity network and should not be used for any other purpose.

11. Please Note: This Overview map does not display UK Power Networks electricity network and should not be used for excavation or other ground works. For details of the electricity network, please refer the relevant page or pages highlighted in the Overview map.

12. Please Note: The Overview map does not display UK Power Networks electricity network and should not be used for excavation or other ground works. For details of the electricity network, please refer the relevant page or pages highlighted in the Overview map.

13. Please Note: The Overview map does not display UK Power Networks electricity network and should not be used for excavation or other ground works. For details of the electricity network, please refer the relevant page or pages highlighted in the Overview map.

14. Please Note: The Overview map does not display UK Power Networks electricity network and should not be used for excavation or other ground works. For details of the electricity network, please refer the relevant page or pages highlighted in the Overview map.

15. Please Note: The Overview map does not display UK Power Networks electricity network and should not be used for excavation or other ground works. For details of the electricity network, please refer the relevant page or pages highlighted in the Overview map.

16. Please Note: The Overview map does not display UK Power Networks electricity network and should not be used for excavation or other ground works. For details of the electricity network, please refer the relevant page or pages highlighted in the Overview map.

17. Please Note: The Overview map does not display UK Power Networks electricity network and should not be used for excavation or other ground works. For details of the electricity network, please refer the relevant page or pages highlighted in the Overview map.

18. Please Note: The Overview map does not display UK Power Networks electricity network and should not be used for excavation or other ground works. For details of the electricity network, please refer the relevant page or pages highlighted in the Overview map.

19. Please Note: The Overview map does not display UK Power Networks electricity network and should not be used for excavation or other ground works. For details of the electricity network, please refer the relevant page or pages highlighted in the Overview map.

20. Please Note: The Overview map does not display UK Power Networks electricity network and should not be used for excavation or other ground works. For details of the electricity network, please refer the relevant page or pages highlighted in the Overview map.

21. Please Note: The Overview map does not display UK Power Networks electricity network and should not be used for excavation or other ground works. For details of the electricity network, please refer the relevant page or pages highlighted in the Overview map.

22. Please Note: The Overview map does not display UK Power Networks electricity network and should not be used for excavation or other ground works. For details of the electricity network, please refer the relevant page or pages highlighted in the Overview map.

23. Please Note: The Overview map does not display UK Power Networks electricity network and should not be used for excavation or other ground works. For details of the electricity network, please refer the relevant page or pages highlighted in the Overview map.

UK Power Networks

ALWAYS LOOK UP BEFORE YOU DIG
 Refer to HSE Guidance note GS6

IF IN DOUBT - ASK PHONE 0800 056 586
 For more information on the damage a cable or line can cause call on the URGENTLY Phone 0800 783 8838 (24hrs)

Also produced at 1:2500 scale are GeoSchematics which show LV mains cables and overhead lines (in some cases all voltages). Prior to carrying out excavations you must refer to the 1:500 records to determine the location of all known underground plant and equipment.

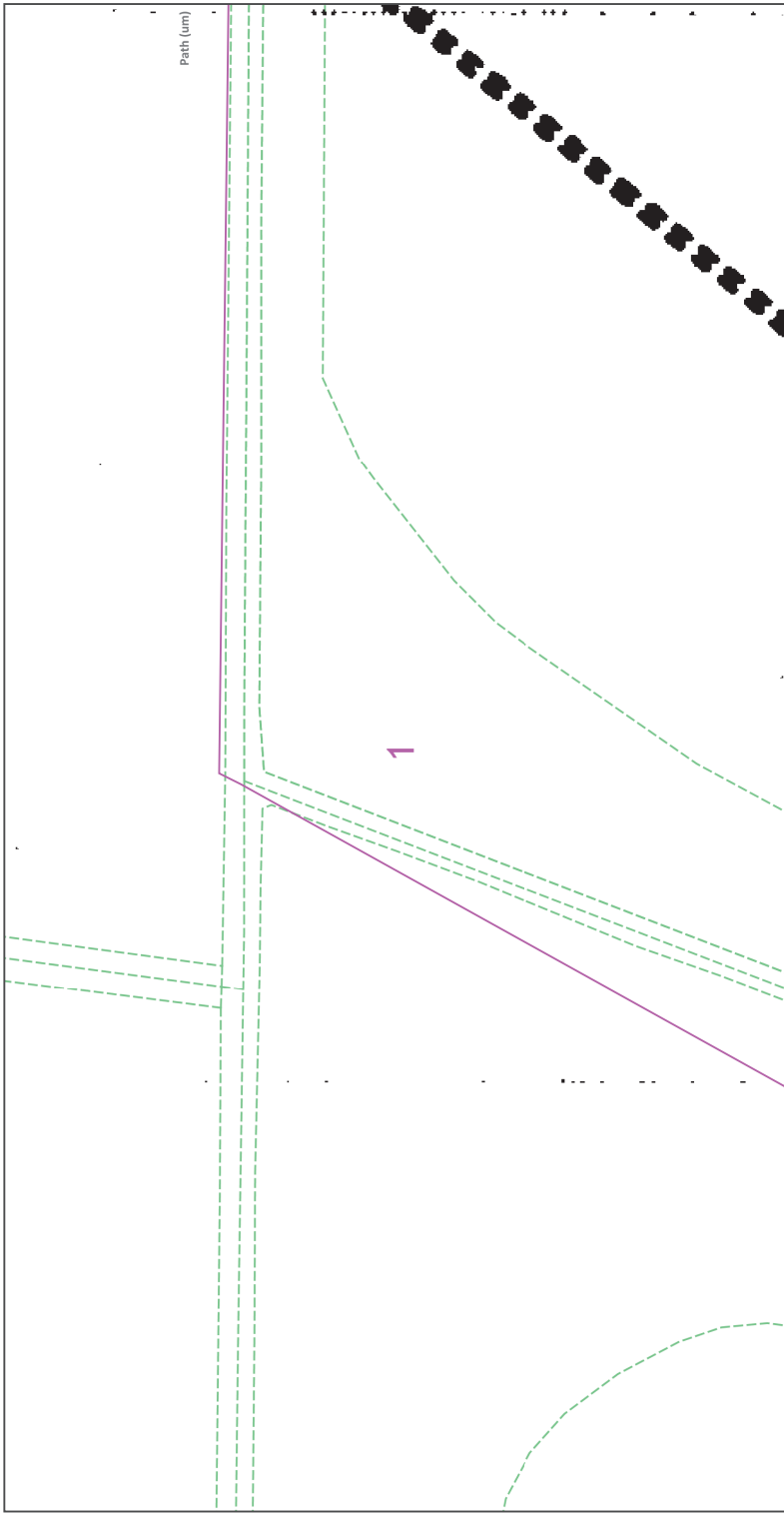

<p>This plan must be used with the attached 'Symbols' document.</p> <p>Date Requested: 23/07/2021 Job Reference: 22778282 Site Location: 517403_204375 Requested by: Mrs Amy Helford Your Scheme/Reference: 26728 Scale: 1:500 (When plotted at A4)</p>	<p>The quality and accuracy of any print will depend on your printer, your computer and its print settings. Measurements scaled from this plan may not match measurements between the same points on the ground.</p> <p>1. UK Power Networks does not warrant that the information provided to you is correct. You rely upon it at your own risk. UK Power Networks does not exclude or limit its liability if it causes the death of any persons or causes personal injury to a person.</p> <p>2. This plan is for your information only. It is not intended to be used as a substitute for any professional advice or engineering advice or other work for any task, damage, cost, claim, demands, or expenses that you or any third party may suffer or incur as a result of using the information provided whether for physical damage to property or for any economic loss or any special or consequential loss or damage whatsoever.</p> <p>3. This plan has been provided to you on the basis of the terms of the order set out in the covering letter that accompanies this plan and you must return it to the sender of this letter.</p> <p>4. This plan is not to be used for any other purpose and the copyright in this plan shall be deemed to remain with UK Power Networks and must not be copied, reproduced, or transmitted in any form or by any means, electronic, mechanical, photocopying, recording, or by any information storage and retrieval system, without the prior written permission of UK Power Networks.</p> <p>5. All cables must be treated as being live unless proved otherwise by UK Power Networks.</p> <p>6. The information provided must be given to all people who dig near UK Power Networks plant and equipment.</p> <p>7. Please be aware that electric cables/wires belonging to other owners of licensed electricity supply are not shown on this plan.</p> <p>8. Please be aware that Low Voltage Overhead power lines are not currently displayed for the Eastern Region via this service; if you require records on the location of these please contact our Plan Production Enquiry via plans@powernetworks.co.uk.</p>		
<p>1. The position of the apparatus shown on this drawing is believed to be correct but the original landmarks may have been altered since the apparatus was installed.</p> <p>2. The information provided must be given to all people who dig near UK Power Networks plant and equipment.</p> <p>3. It must be assumed that there is a service cable into each property, lamp column and street sign, until the exact location of all the cables has been determined.</p> <p>4. It must be assumed that there is a service cable into each property, lamp column and street sign, until the exact location of all the cables has been determined.</p> <p>5. All cables must be treated as being live unless proved otherwise by UK Power Networks.</p> <p>6. The information provided must be given to all people who dig near UK Power Networks plant and equipment.</p> <p>7. Please be aware that electric cables/wires belonging to other owners of licensed electricity supply are not shown on this plan.</p> <p>8. Please be aware that Low Voltage Overhead power lines are not currently displayed for the Eastern Region via this service; if you require records on the location of these please contact our Plan Production Enquiry via plans@powernetworks.co.uk.</p>	<p>IF IN DOUBT - ASK PHONE 0800 054 586 EMERGENCY CALLS - 999 Phone 0800 783 8838 (24hrs) URGENTLY</p>	<p>ALWAYS LOOK UP BEFORE YOU DIG Refer to HSE Guidance note G56</p>	<p>Also produced at 1:2500 scale are GeoSchematics which show LV mains cables and overhead lines (in some cases all voltages). Prior to carrying out excavations you must refer to the 1:500 records to determine the location of all known underground plant and equipment.</p>

Reproduced by permission of Ordnance Survey on behalf of HMASO. © Crown copyright and database right, 2020. All rights reserved. Ordnance Survey Licence numbers 100019626, 100019626 and 100019450. Data has been added to the Ordnance Survey base map; all proprietary rights in such additional data are and shall remain the exclusive property of © London Power Networks plc or Eastern Power Networks plc or South Eastern Power Networks plc, each being a distribution licensee under section 6(1)(c) of the Electricity Act 1989 for the relevant distribution service area as that term is defined in such licensee's distribution licence. All rights in such data reserved.

Plans generated by digSAFE Pro™ software provided by UnearthorTechnology.

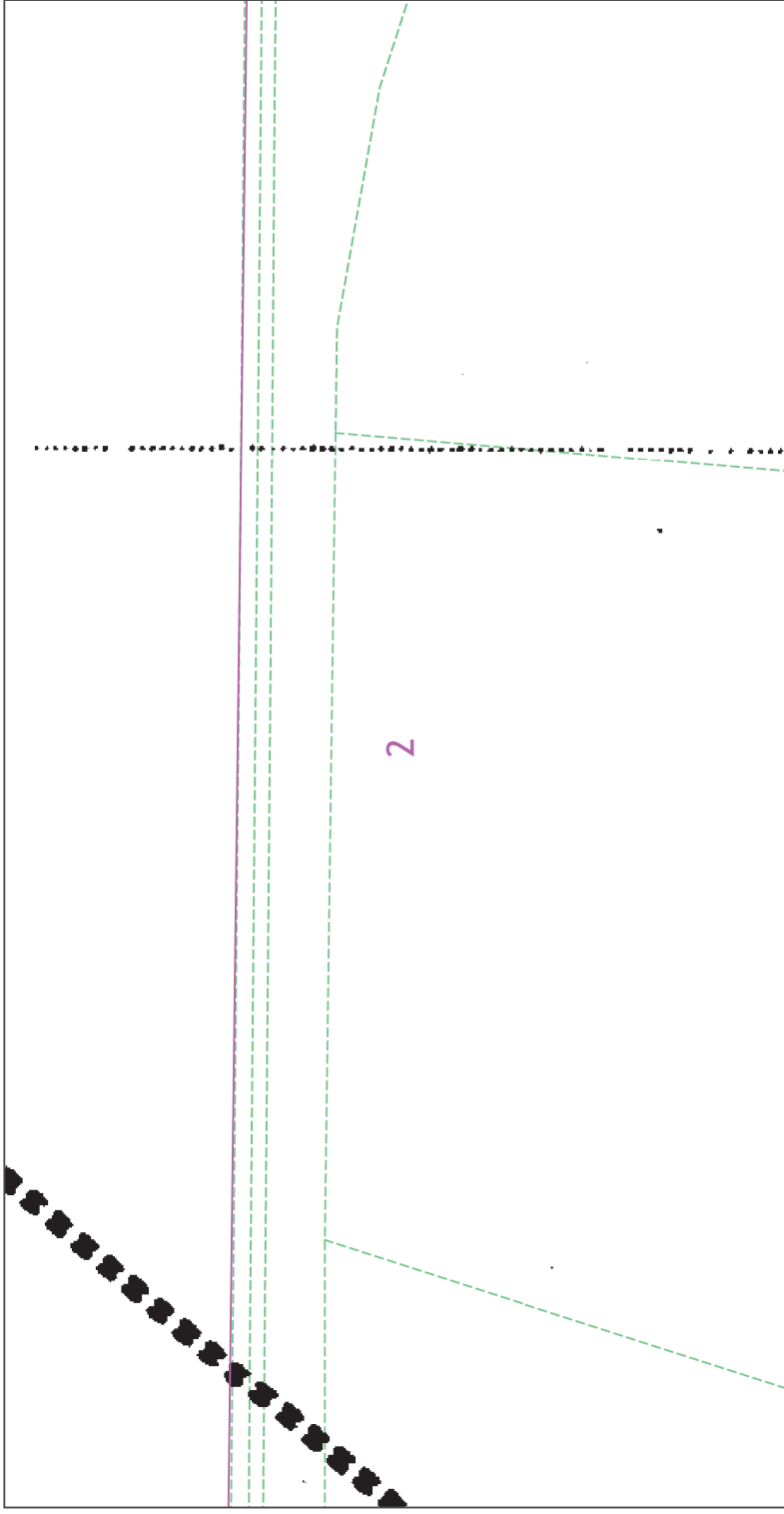

This plan must be used with the attached 'Symbols' document.

Date Requested: 23/07/2021
 Job Reference: 22778282
 Site Location: 517403_204375
 Requested by: Mrs Amy Helford
 Your Scheme/Reference: 26728
 Scale: 1:500 (When plotted at A4)

Reproduced by permission of Ordnance Survey on behalf of HMSO. © Crown copyright and database right. 2020. All rights reserved. Ordnance Survey Licence numbers 100079626, 100019626 and 100019450. Data has been added to the Ordnance Survey base map; all proprietary rights in such additional data are and shall remain the exclusive property of © London Power Networks plc or Eastern Power Networks plc or South Eastern Power Networks plc, each being a distribution licensee under section 6(1)(c) of the Electricity Act 1989 for the relevant distribution service area as that term is defined in such licensee's distribution licence. All rights in such data reserved.
 Plans generated by digMAP Pro™ software provided by UnearthedTechnology.

0 1.25 2.5 metres

Dig Sites **Area:** **Line:**

The quality and accuracy of any print will depend on your printer, your computer and its print settings. Measurements scaled from this plan may not match measurements between the same points on the ground.

1. UK Power Networks does not warrant that the information provided to you is correct. You rely upon it at your own risk. UK Power Networks does not exclude or limit its liability if it causes the death of any person or causes personal injury to a person.

2. This plan is provided to you as a guide only. It is not intended to be used as a substitute for a site visit or as a substitute for any other data or information that you may require for your own purposes. UK Power Networks does not accept any liability for any loss, damage, cost, claim, demands, or expenses that you or any third party may suffer or incur as a result of using the information provided whether for physical damage to property or for any economic loss or any other loss, including but not limited to, loss of savings, loss of goodwill, loss of business, loss of use of any or any special or consequential loss or damage whatsoever.

3. This plan has been provided to you on the basis of the terms of the order set out in the covering letter that accompanies this plan. It is provided to you on the basis of the information provided to us by you and the information provided to us by the relevant third parties. UK Power Networks does not accept any liability for any loss, damage or expense that you or any third party may suffer or incur as a result of using the information provided to you. It must not be given, sold or made available to any other person without the prior written consent of UK Power Networks.

4. Please Note: This Overview map does not display UK Power Networks electricity network and should not be used for any other purpose than the one for which it was provided. For details of the electricity network, please view the relevant page or pages of the relevant map.

5. All cables must be treated as being a service cable into each property, lamp column and street sign.

6. The information provided must be given to all people who dig near UK Power Networks plan and cables. It is your responsibility to ensure that all relevant parties are aware of the location of the cables. The use of mechanical tools or picks until the exact location of all the cables has been determined.

7. Please be aware that electric cables/lines belonging to other owners of licensed electricity supply are not shown on this plan. It is your responsibility to ensure that you are aware of the location of these cables/lines.

8. Please be aware the Low Voltage Overhead power lines are not currently displayed for the Eastern Region via this service; if you require records on the location of these please contact our Plan Production team directly via plans@unearthedtechnology.co.uk.

IF IN DOUBT - ASK PHONE
 0800 054 586
 EMERGENCY CALLS
 0800 783 8838 (24hrs)
 URGENTLY

ALWAYS LOOK UP BEFORE ANY WORK BEGINS. Refer to HSE Guidance note G56

Also produced at 1:2500 scale are GeoSchematics which show LV mains cables and overhead lines (in some cases all voltages). Prior to carrying out excavations you must refer to the 1:500 records to determine the location of all known underground plant and equipment.

UK Power Networks

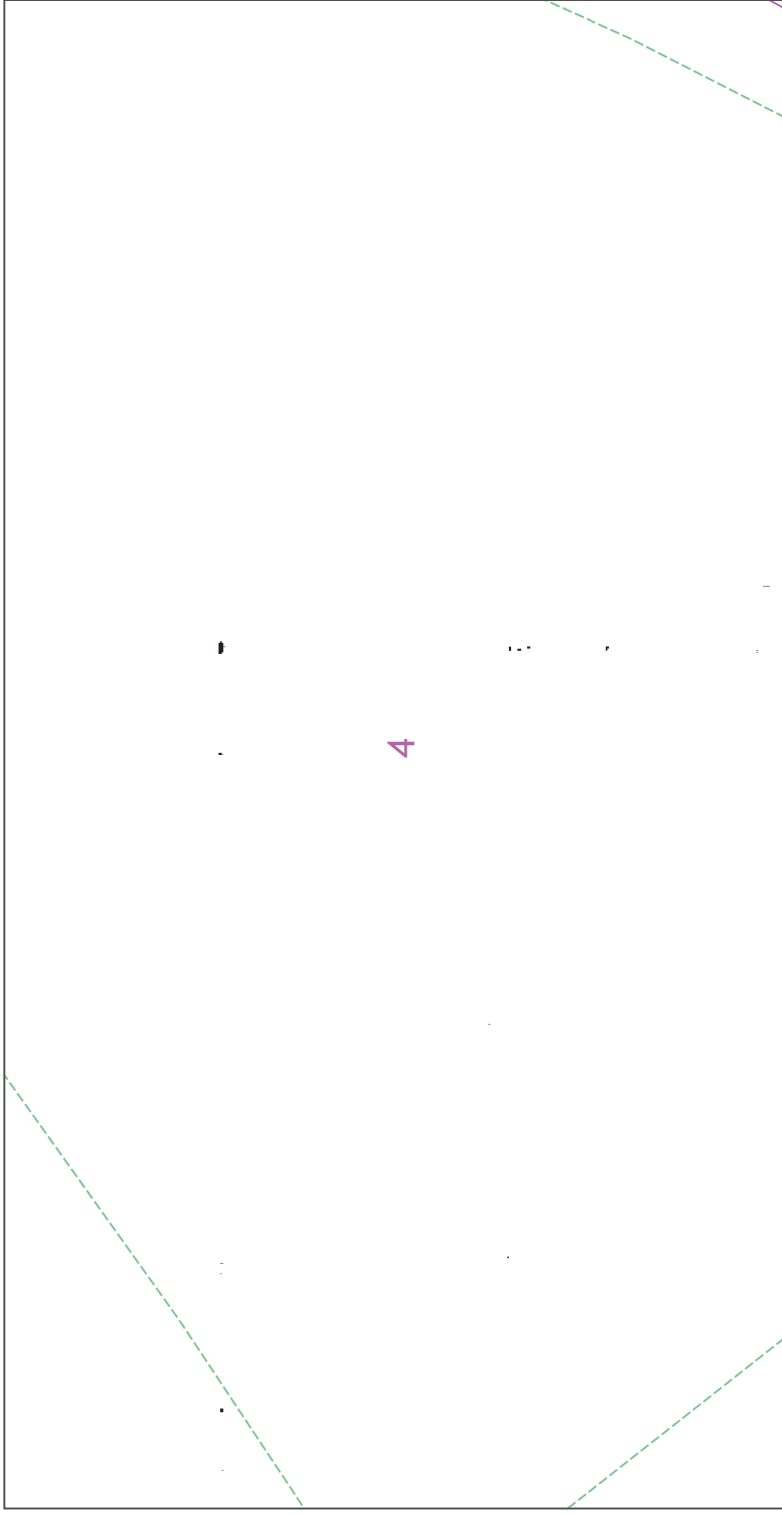

0 12.5 25 metres

This plan must be used with the attached 'Symbols' document.

Date Requested: 23/07/2021

Job Reference: 22778282

Site Location: 517403_204375

Requested by: Mrs Amy Helford

Your Scheme/Reference: 26728

Scale: 1:500 (When plotted at A4)

Dig Sites Area: Line:

1. The position of the apparatus shown on this drawing is believed to be correct but the original landmarks may have been altered since the apparatus was installed. The position of the apparatus should be verified. Use approved cable avoidance tools prior to excavation using suitable hand tools.

2. It must be assumed that there is a service cable into each property, lamp column and street sign, until the exact location of all the cables have been determined.

3. All cables must be treated as being live unless proved otherwise by UK Power Networks.

4. The information provided must be given to all people working near UK Power Networks plant and equipment.

5. Please be aware that electric cables/lines belonging to other owners of licensed electricity supply are not shown on this plan.

6. Please be aware the Low Voltage Overhead power lines are not currently displayed for the Eastern Region via this service. If you require records on the location of these please contact our Plan Provision team directly via plans@opennetworks.co.uk.

The quality and accuracy of any print will depend on your printer, your computer and its print settings. Measurements scaled from this plan may not match measurements between the same points on the ground.

1. UK Power Networks does not warrant that the information provided to you is correct. You rely upon it at your own risk. UK Power Networks does not exclude or limit its liability if it causes the death of any persons or causes personal injury to a person.

2. UK Power Networks does not accept any liability for any loss, damage, cost, claim, demands, or expenses that you or any third party may suffer or incur as a result of using the information provided whether for physical damage to property or for any economic loss.

3. This plan has been provided to you on the basis of the terms of the survey. Loss of savings, loss of goodwill, loss of business, loss of use or any special or consequential loss or damage whatsoever.

4. This plan has been provided to you on the basis of the terms of the survey. Loss of savings, loss of goodwill, loss of business, loss of use or any special or consequential loss or damage whatsoever.

5. The information provided to you, it must not be given, sold or made available upon payment of a fee to a third party.

6. Please Note: The Overview map does not display UK Power Networks electricity network and should not be used for navigation or other purposes. For details of the electricity network, please view the relevant page or pages highlighted in the Overview map.

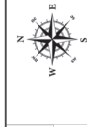

IF IN DOUBT - ASK PHONE
EMERGENCY
0800 056 586
For any damage a
call on the
Phone 0800 783 8838 (24hrs)
URGENTLY



ALWAYS LOOK UP
BEFORE
YOU START WORK
Refer to HSE Guidance
note G56



Also produced at 1:2500 scale are GeoSchematics which show LV mains cables and overhead lines (in some cases all voltages). Prior to carrying out excavations you must refer to the 1:500 records to determine the location of all known underground plant and equipment.

Reproduced by permission of Ordnance Survey on behalf of HMSO. © Crown copyright and database right. 2020. All rights reserved. Ordnance Survey Licence numbers 100019626, 100019626 and 100019450. Data has been added to the Ordnance Survey base map. All proprietary rights in such additional data are and shall remain the exclusive property of © London Power Networks plc or Eastern Power Networks plc or South Eastern Power Networks plc, each being a distribution licensee under section 61(1)(c) of the Electricity Act 1989 for the relevant distribution service area as that term is defined in such licensee's distribution licence. All rights in such data reserved.

Plans generated by digSAFE Pro™ software provided by Unearthor/brodding.

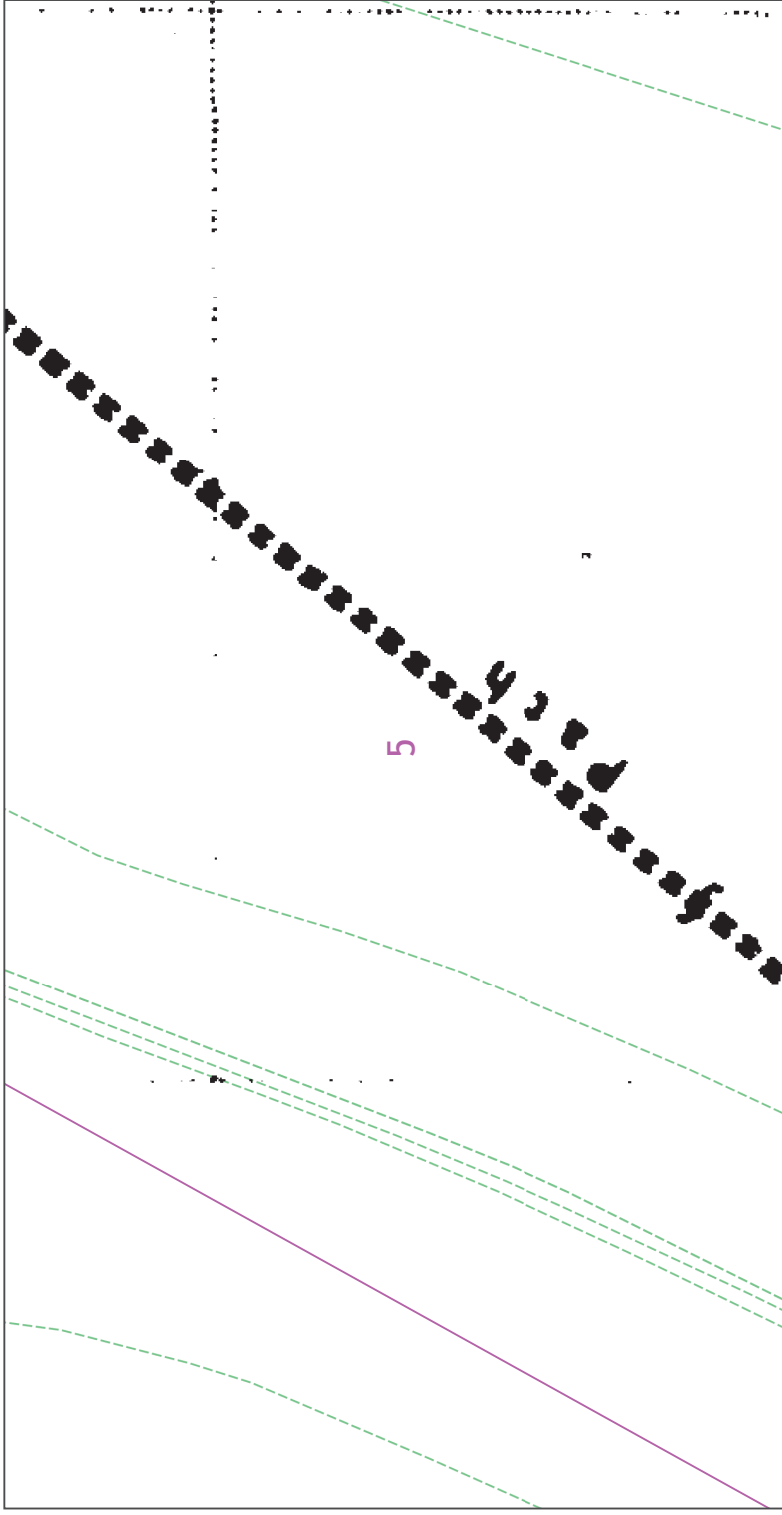

0 12.5 25 metres

This plan must be used with the attached 'Symbols' document.

Date Requested: 23/07/2021

Job Reference: 22778282

Site Location: 517403 204375

Requested by: Mrs Amy Helford

Your Scheme/Reference: 26728

Scale: 1:500 (When plotted at A4)

Dig Sites Area: Line:

1. The position of the apparatus shown on this drawing is believed to be correct but the original landmarks may have been altered since the apparatus was installed. The position of the apparatus should be verified. Use approved cable avoidance tools prior to excavation using suitable hand tools.

2. The information provided must be given to all people working near UK Power Networks plant and equipment. The information provided must be given to all owners of licensed electricity cables in the area.

3. It must be assumed that there is a service cable into each property, lamp column and street sign, until the exact location of all the cables has been determined.

4. It must be assumed that there is a service cable into each property, lamp column and street sign, until the exact location of all the cables has been determined.

5. All cables must be treated as being live unless proved otherwise by UK Power Networks.

6. The information provided must be given to all people working near UK Power Networks plant and equipment. The information provided must be given to all owners of licensed electricity cables in the area.

7. Please be aware that electric cables/lines belonging to other owners of licensed electricity cables in the area may not be shown on this drawing.

8. Please be aware that Low Voltage overhead power lines are not currently displayed for the Eastern Region via this service. If you require records on the location of these please contact our Plan Protection team directly via plans@opennetworks.co.uk.

The quality and accuracy of any print will depend on your printer, your computer and its print settings. Measurements scaled from this plan may not match measurements between the same points on the ground.

1. UK Power Networks does not warrant that the information provided to you is correct. You rely upon it at your own risk. UK Power Networks does not exclude or limit its liability if it causes the death of any persons or causes personal injury to a person.

2. UK Power Networks does not warrant that the information provided to you is correct. You rely upon it at your own risk. UK Power Networks does not exclude or limit its liability if it causes the death of any persons or causes personal injury to a person.

3. UK Power Networks does not warrant that the information provided to you is correct. You rely upon it at your own risk. UK Power Networks does not exclude or limit its liability if it causes the death of any persons or causes personal injury to a person.

4. This plan has been provided to you on the basis of the terms of use set out in the covering letter that accompanies this plan and must return it to the sender of this letter.

5. UK Power Networks does not warrant that the information provided to you is correct. You rely upon it at your own risk. UK Power Networks does not exclude or limit its liability if it causes the death of any persons or causes personal injury to a person.

6. Please Note: This Overview map does not display UK Power Networks electricity network and should not be used for excavation or other work. For details of the electricity network, please view the relevant page or pages highlighted in the Overview map.



IF IN DOUBT - ASK PHONE
EMERGENCY
0800 054 586
0800 054 586
0800 783 8838 (24hrs)
URGENTLY



ALWAYS LOOK UP
BEFORE
YOU START ANY WORK
Refer to HSE Guidance
note G56

Also produced at 1:500 scale are GeoSchematics which show LV mains cables and overhead lines (in some cases all voltages). Prior to carrying out excavations you must refer to the 1:500 records to determine the location of all known underground plant and equipment.



Reproduced by permission of Ordnance Survey on behalf of HMSO. © Crown copyright and database right, 2020. All rights reserved. Ordnance Survey Licence numbers 100019626, 100019626 and 100019450. Data has been added to the Ordnance Survey base map. All proprietary rights in such additional data are and shall remain the exclusive property of © London Power Networks plc or Eastern Power Networks plc or South Eastern Power Networks plc, each being a distribution licensee under section 6(1)(c) of the Electricity Act 1989 for the relevant distribution service area as that term is defined in such licensee's distribution licence. All rights in such data reserved. Plans generated by digSAFE Pro™ software provided by Unearthor/brodding.

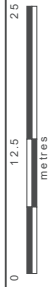
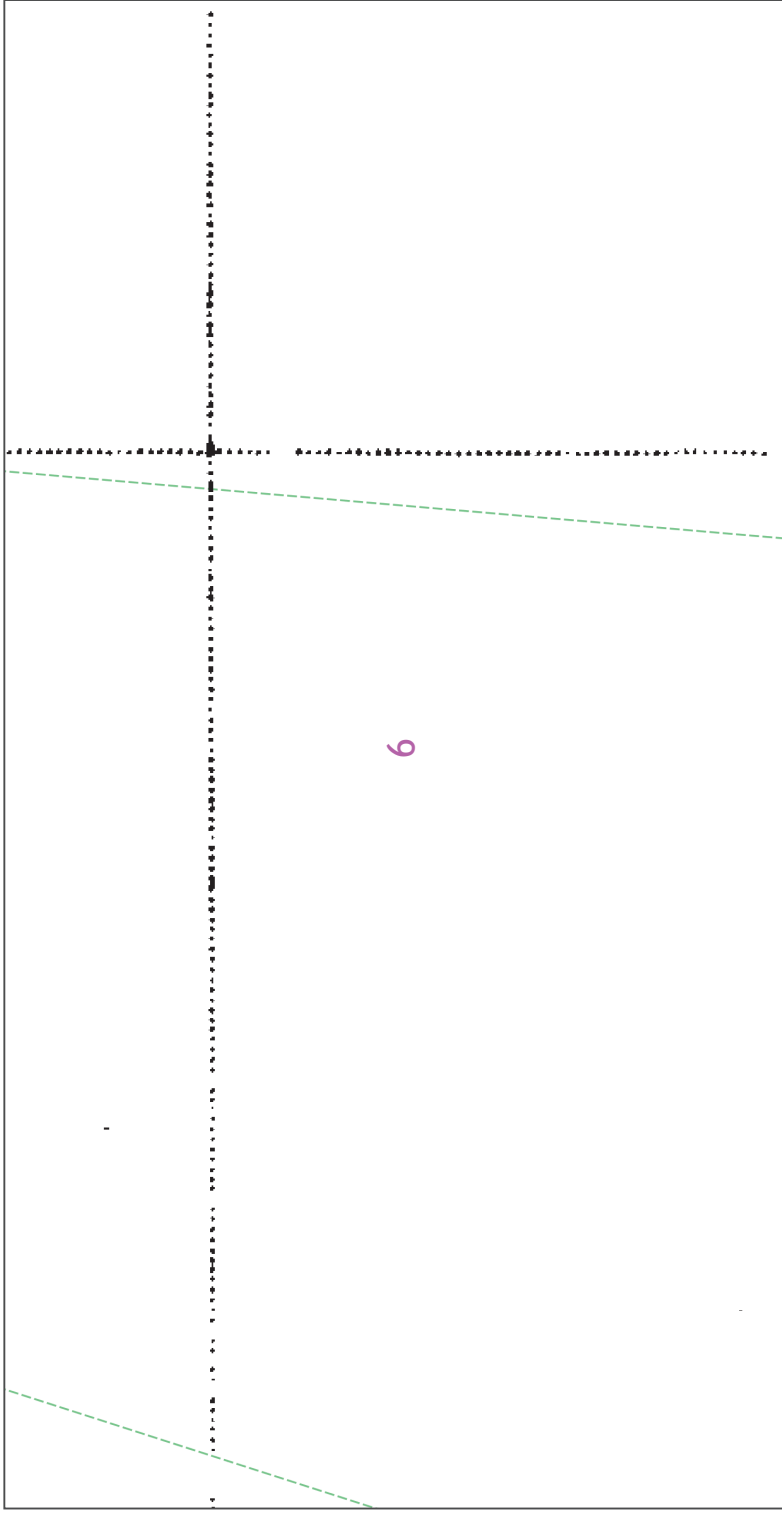

This plan must be used with the attached 'Symbols' document.

Date Requested: 23/07/2021

Job Reference: 22778282

Site Location: 517403_204375

Requested by: Mrs Amy Helford

Your Scheme/Reference: 26728

Scale: 1:500 (When plotted at A4)

Dig Sites Area: Line:

1. The position of the apparatus shown on this drawing is believed to be correct but the original landmarks may have been altered since the apparatus was installed. The position of the apparatus should be verified using approved cable avoidance tools prior to excavation using suitable hand tools.

2. The information provided is for your information only and does not constitute an offer of any service. The use of mechanical tools or picks until the exact location of all the cables has been determined.

3. All cables must be treated as being a service cable into each property, lamp column and street sign.

4. The information provided must be given to all people working near UK Power Networks plant and equipment.

5. Please be aware that electric cables/lines belonging to other owners of licensed electricity supply are not shown on this plan.

6. Please be aware the Low Voltage overhead power lines are not currently displayed for the Eastern Region via this service; if you require records on the location of these please contact our Plan Production directly via plans@powernetworks.co.uk.

The quality and accuracy of any print will depend on your printer, your computer and its print settings. Measurements scaled from this plan may not match measurements between the same points on the ground.

1. UK Power Networks does not warrant that the information provided to you is correct. You rely upon it at your own risk. UK Power Networks does not exclude or limit its liability if it causes the death of any persons or causes personal injury to a person.

2. UK Power Networks does not accept any liability for any loss, damage, cost, claim, demands, or expenses that you or any third party may suffer or incur as a result of using the information provided whether for physical damage to property or for any economic loss.

3. This plan has been provided to you on the basis of the terms of use set out in the covering letter that accompanies this plan and must return it to the sender of this letter.

4. This plan has been provided to you on the basis of the terms of use set out in the covering letter that accompanies this plan and must return it to the sender of this letter.

5. This plan has been provided to you on the basis of the terms of use set out in the covering letter that accompanies this plan and must return it to the sender of this letter.

6. Please Note: This Overview map does not display UK Power Networks electricity network and should not be used for navigation or other purposes. For details of the electricity network, please view the relevant page or pages highlighted in the Overview map.



IF IN DOUBT - ASK PHONE
EMERGENCY
0800 054 586
call on the damage a
cable or the damage a
Phone 0800 783 8838 (24hrs)
URGENTLY



ALWAYS LOOK UP
BEFORE
YOU WORK
Refer to HSE Guidance
note G56

Also produced at 1:2500 scale are GeoSchematics which show LV mains cables and overhead lines (in some cases all voltages). Prior to carrying out excavations you must refer to the 1:500 records to determine the location of all known underground plant and equipment.

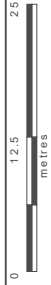
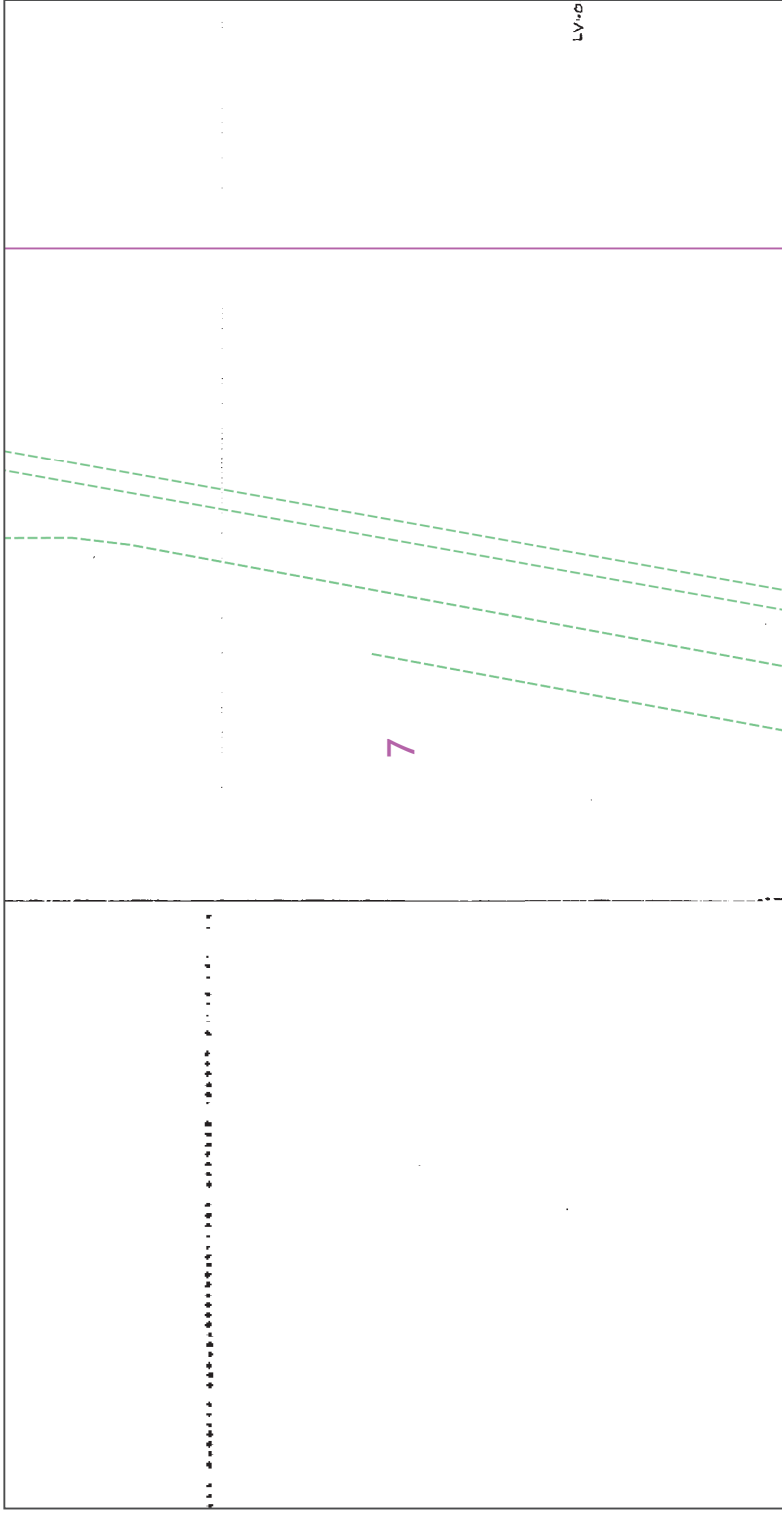

This plan must be used with the attached 'Symbols' document.

Date Requested: 23/07/2021

Job Reference: 22778282

Site Location: 517403_204375

Requested by: Mrs Amy Helford

Your Scheme/Reference: 26728

Scale: 1:500 (When plotted at A4)

Reproduced by permission of Ordnance Survey on behalf of HMASO. © Crown copyright and database right, 2020. All rights reserved. Ordnance Survey Licence numbers 100079626, 100019826 and 100019450. Data has been added to the Ordnance Survey base map; all proprietary rights in such additional data are and shall remain the exclusive property of © London Power Networks plc or South Eastern Power Networks plc, each being a distribution licensee under section 6(1)(c) of the Electricity Act 1989 for the relevant distribution service area as that term is defined in such licensee's distribution licence. All rights in such data reserved. Plans generated by digMAP Pro™ software provided by UnearthedIntelligence.

The quality and accuracy of any print will depend on your printer, your computer and its print settings. Measurements scaled from this plan may not match measurements between the same points on the ground.

1. UK Power Networks does not warrant that the information provided to you is correct. You rely upon it at your own risk. UK Power Networks does not exclude or limit its liability if it causes the death of any persons or causes personal injury to a person.

2. UK Power Networks does not accept any liability for any loss of data, damage, cost, claim, demands, or expenses that you or any third party may suffer or incur as a result of using the information provided whether for physical damage to property or for any economic loss.

3. This plan has been provided to you on the basis of the terms of use set out in the covering letter that accompanies this plan and must be returned to the sender of this letter.

4. This plan has been provided to you on the basis of the terms of use set out in the covering letter that accompanies this plan and must be returned to the sender of this letter.

5. Please be aware that electric cables/lines belonging to other owners of licensed electricity supply are not shown on this plan. You should check with the relevant owner for the location of these cables/lines. Please be aware that Low Voltage overhead power lines are not currently displayed for the Eastern Region via this service; if you require records on the location of these please contact our Plan Production team directly via plans@unearthedint.co.uk.



IF IN DOUBT - ASK PHONE
EMERGENCY 0800 056 586
For all other enquiries call on the Customer Care line on 0800 783 8838 (24hrs)
URGENTLY



ALWAYS LOOK UP BEFORE ANY WORK BEGINS. Refer to HSE Guidance note GS6



LV-0

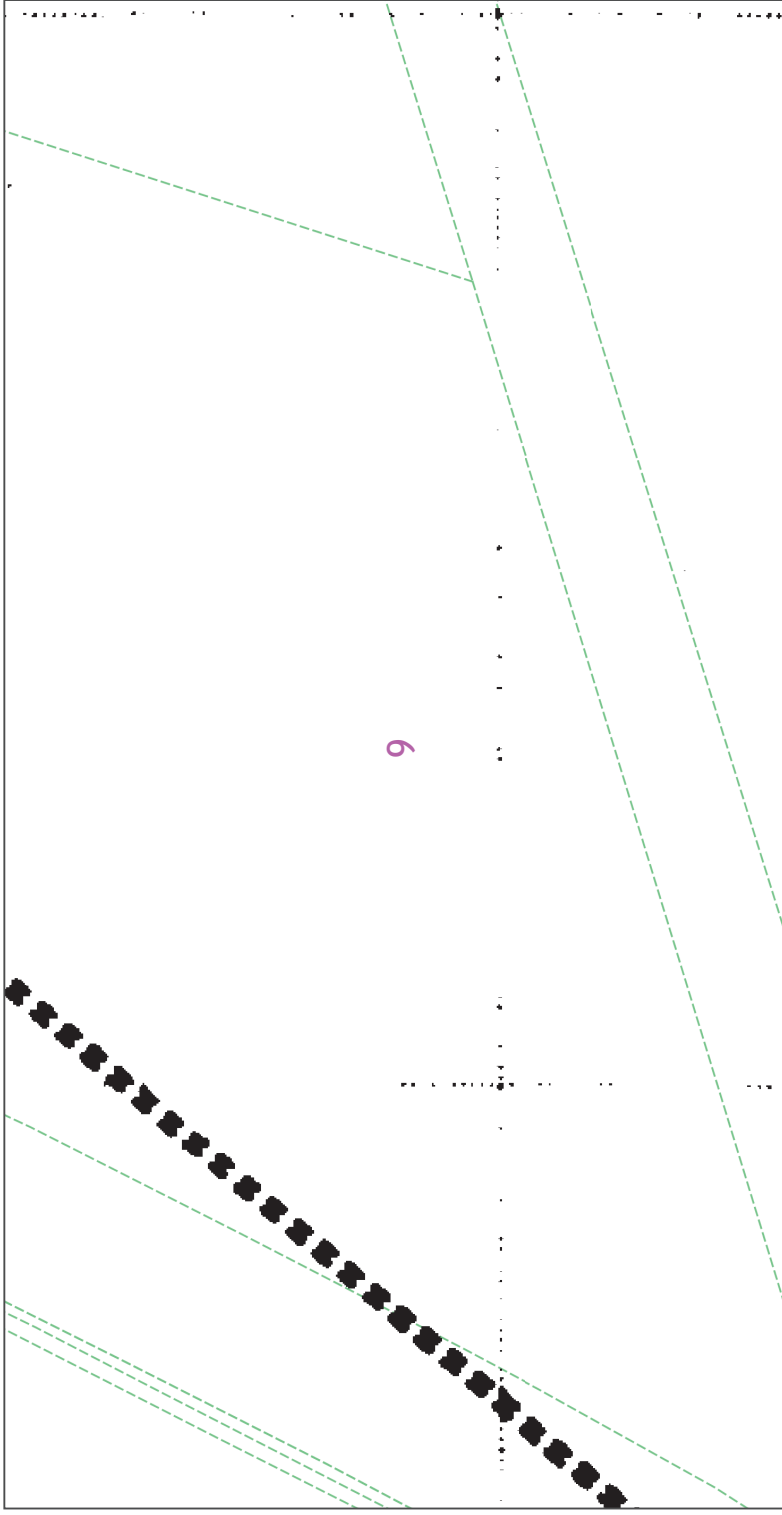

This plan must be used with the attached 'Symbols' document.

Date Requested: 23/07/2021
 Job Reference: 22778282
 Site Location: 517403 204375
 Requested by: Mrs Amy Helford
 Your Scheme/Reference: 26728
 Scale: 1:500 (When plotted at A4)

Reproduced by permission of Ordnance Survey on behalf of HMSO. © Crown copyright and database right, 2020. All rights reserved. Ordnance Survey Licence numbers 100019626, 100019626 and 100019450. Data has been added to the Ordnance Survey base map. All proprietary rights in such additional data are and shall remain the exclusive property of © London Power Networks plc or Eastern Power Networks plc or South Eastern Power Networks plc, each being a distribution licensee under section 6(1)(c) of the Electricity Act 1989 for the relevant distribution service area as that term is defined in such licensee's distribution licence. All rights in such data reserved.

Plans generated by digSAFE Pro™ software provided by UnearthedHoldings.

0 12.5 25 metres

Dig Sites Area: **Line:**

The quality and accuracy of any print will depend on your printer, your computer and its print settings. Measurements scaled from this plan may not match measurements between the same points on the ground.

1. UK Power Networks does not warrant that the information provided to you is correct. You rely upon it at your own risk. UK Power Networks does not exclude or limit its liability if it causes the death of any person or causes personal injury to a person.

2. UK Power Networks does not accept any liability for any loss of data, damage to equipment, or any other loss or damage, whether or not caused in whole or in part by the use of mechanical tools or picks to excavation using suitable hand tools.

3. It must be assumed that there is a service cable into each property, lamp column and street sign, until the exact location of all the cables has been determined.

4. It must be assumed that there is a service cable into each property, lamp column and street sign.

5. All cables must be treated as being live unless proved otherwise by UK Power Networks.

6. The information provided must be given to all people working on UK Power Networks plant and equipment.

7. Please be aware that electric cables/lines belonging to other owners of licensed electricity supply are not shown on this plan.

8. Please be aware the Low Voltage Overhead power lines are not currently displayed for the Eastern Region via this service; if you require records on the location of these please contact our Plan Provision team directly via plans@unearthedholdings.co.uk.

1. UK Power Networks does not warrant that the information provided to you is correct. You rely upon it at your own risk. UK Power Networks does not exclude or limit its liability if it causes the death of any person or causes personal injury to a person.

2. UK Power Networks does not accept any liability for any loss of data, damage to equipment, or any other loss or damage, whether or not caused in whole or in part by the use of mechanical tools or picks to excavation using suitable hand tools.

3. It must be assumed that there is a service cable into each property, lamp column and street sign, until the exact location of all the cables has been determined.

4. It must be assumed that there is a service cable into each property, lamp column and street sign.

5. All cables must be treated as being live unless proved otherwise by UK Power Networks.

6. The information provided to you on the basis of the terms of use set out in the covering letter that accompanies this plan and must return it to the sender of this letter.

7. Please be aware that electric cables/lines belonging to other owners of licensed electricity supply are not shown on this plan.

8. Please be aware the Low Voltage Overhead power lines are not currently displayed for the Eastern Region via this service; if you require records on the location of these please contact our Plan Provision team directly via plans@unearthedholdings.co.uk.

6. Please Note: This Overview map does not display UK Power Networks electricity network and should not be used for excavation purposes. For details of the electricity network, please view the relevant page or records to determine the location of all known underground plant and equipment.

Also produced at 1:2500 scale are GeoSchematics which show LV mains cables and overhead lines (in some cases all voltages). Prior to carrying out excavations you must refer to the 1:500 records to determine the location of all known underground plant and equipment.



IF IN DOUBT - ASK PHONE
 0800 054 586
 OR VISIT www.ukpn.co.uk FOR FURTHER INFORMATION
 OR CALL OUR 24 HOUR EMERGENCY
 PHONE 0800 783 8838 (24hrs)
 URGENTLY



ALWAYS LOOK UP
 BEFORE
 DIGGING
 Refer to HSE Guidance
 note G56

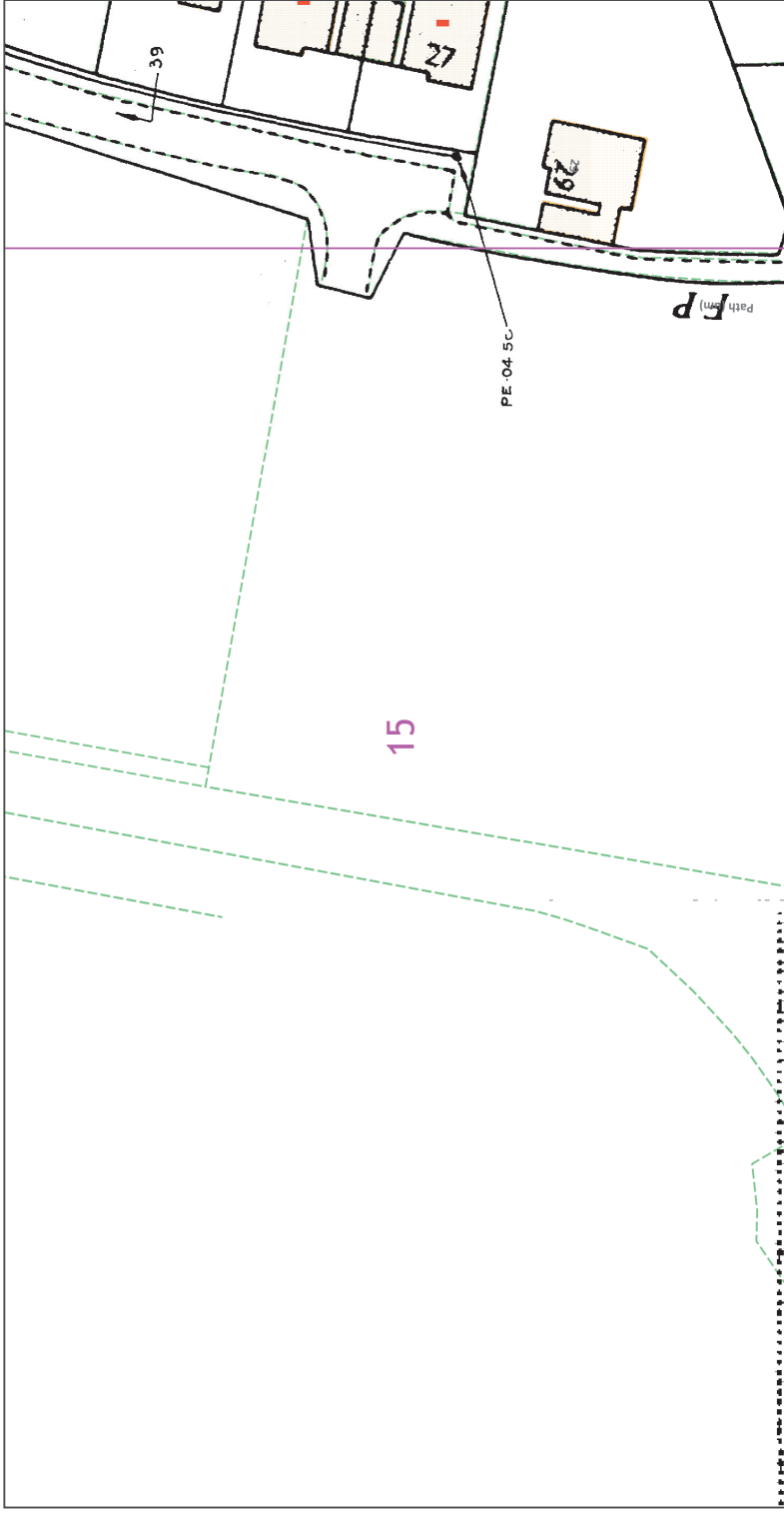

This plan must be used with the attached 'Symbols' document.

Date Requested: 23/07/2021
 Job Reference: 22778282
 Site Location: 517403_204375
 Requested by: Mrs Amy Helford
 Your Scheme/Reference: 26728
 Scale: 1:500 (When plotted at A4)

Reproduced by permission of Ordnance Survey on behalf of HMSO. © Crown copyright and database right, 2020. All rights reserved. Ordnance Survey Licence numbers 100079626, 100019626 and 100019450. Data has been added to the Ordnance Survey base map. All proprietary rights in such additional data are and shall remain the exclusive property of © London Power Networks plc or Eastern Power Networks plc or South Eastern Power Networks plc, each being a distribution licensee under section 6(1)(c) of the Electricity Act 1989 for the relevant distribution service area as that term is defined in such licensee's distribution licence. All rights in such data reserved.
 Plans generated by digMAP Pro™ software provided by Unearthchordholding.

The quality and accuracy of any print will depend on your printer, your computer and its print settings. Measurements scaled from this plan may not match measurements between the same points on the ground.

1. UK Power Networks does not warrant that the information provided to you is correct. You rely upon it at your own risk. UK Power Networks does not exclude or limit its liability if it causes the death of any person or causes personal injury to a person.

2. UK Power Networks does not accept any liability for any damage, cost, claim, demands, or expenses that you or any third party may suffer or incur as a result of using the information provided whether for physical damage to property or for any economic loss of any or any special or consequential loss or damage whatsoever.

3. This plan has been provided to you on the basis of the terms of the use set out in the covering letter that accompanies this plan and must be returned to the sender of this letter.

4. This plan is provided to you on the basis of the terms of the use set out in the covering letter that accompanies this plan and must be returned to the sender of this letter.

5. The information provided to you, it must not be given, sold or made available upon payment of a fee to a third party.

6. Please Note: This Overview map does not display UK Power Networks electricity network and should not be used for excavation or other work. For details of the electricity network, please view the relevant page or pages highlighted in the Overview map.

7. UK Power Networks does not accept any liability for any damage, cost, claim, demands, or expenses that you or any third party may suffer or incur as a result of using the information provided whether for physical damage to property or for any economic loss of any or any special or consequential loss or damage whatsoever.

8. Please be aware that electric cables/lines belonging to other owners of licensed electricity supply are not shown on this plan. Please be aware that Low Voltage overhead power lines are not currently displayed for the Eastern Region via this service; if you require records on the location of these please contact our Plan Production directly via plans@unearthchord.com.

Dig Sites Area: **Line:**

UK Power Networks

IF IN DOUBT - ASK PHONE
 0800 056 586
 24 hours a day, 7 days a week
 Phone 0800 783 8838 (24hrs)
URGENTLY

ALWAYS LOOK UP BEFORE YOU DIG
 Refer to HSE Guidance note G56

LOOK UP

Also produced at 1:2500 scale are GeoSchematics which show LV mains cables and overhead lines (in some cases all voltages). Prior to carrying out excavations you must refer to the 1:500 records to determine the location of all known underground plant and equipment.

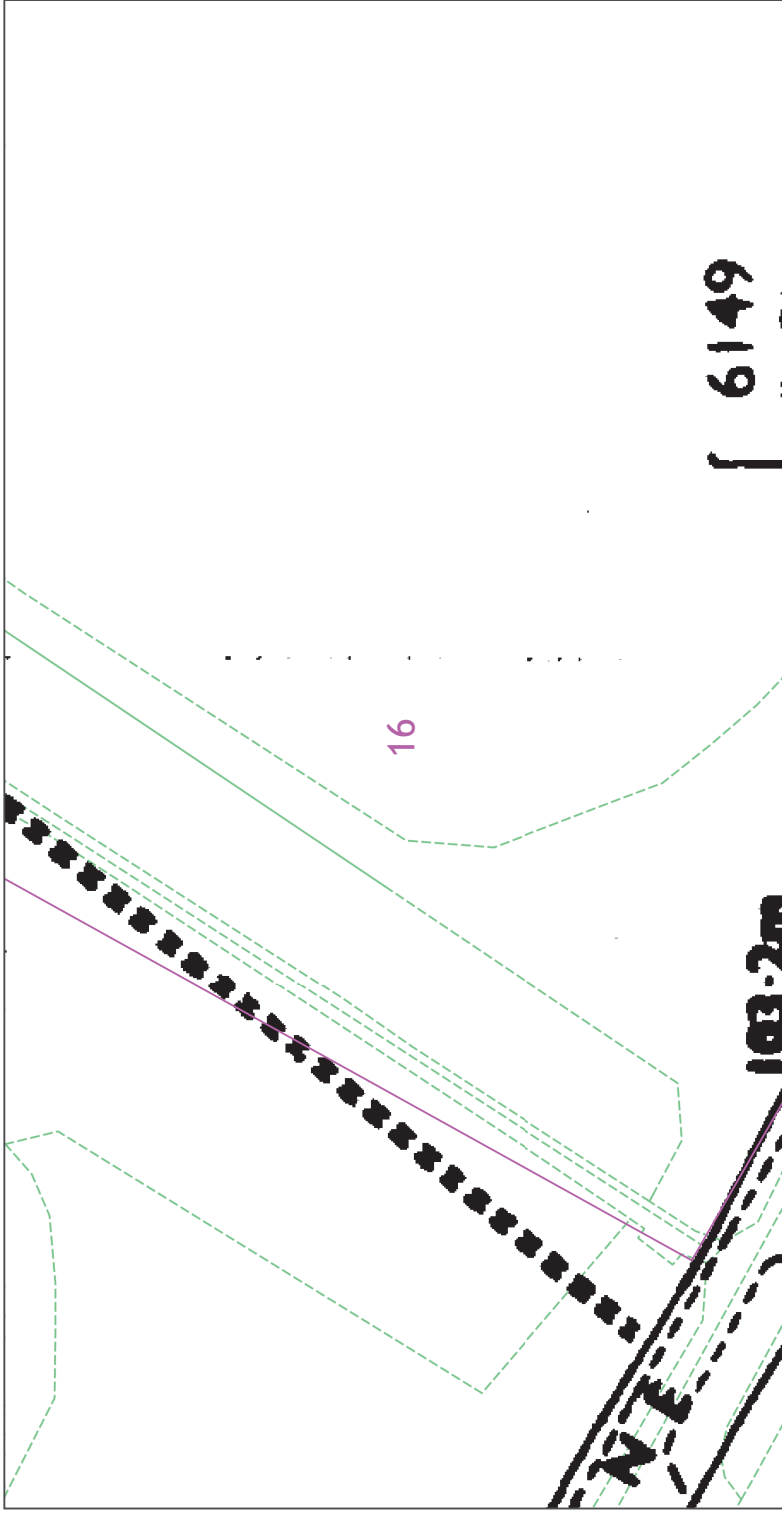

This plan must be used with the attached 'Symbols' document.

Date Requested: 23/07/2021
 Job Reference: 22778282
 Site Location: 517403_204375
 Requested by: Mrs Amy Helford
 Your Scheme /Reference: 26728
 Scale: 1:500 (When plotted at A4)

Reproduced by permission of Ordnance Survey on behalf of HMSO. © Crown copyright and database right, 2020. All rights reserved. Ordnance Survey Licence numbers 100019626, 100019626 and 100019450. Data has been added to the Ordnance Survey base map. All proprietary rights in such additional data are and shall remain the exclusive property of © London Power Networks plc or Eastern Power Networks plc or South Eastern Power Networks plc, each being a distribution licensee under section 6(1)(c) of the Electricity Act 1989 for the relevant distribution service area as that term is defined in such licensee's distribution licence. All rights in such data reserved.

Plans generated by digMAP Pro™ software provided by UnearthedBridging.

1. The position of the apparatus shown on this drawing is believed to be correct but the original landmarks may have been altered since the apparatus was installed.
 2. The position of the apparatus should be verified using approved cable avoidance tools prior to excavation using suitable hand tools.
 3. It must be assumed that there is a service cable into each property, lamp column and street sign, until the exact location of all the cables has been determined.
 4. It must be assumed that there is a service cable into each property, lamp column and street sign.
 5. All cables must be treated as being live unless proved otherwise by UK Power Networks.
 6. The information provided must be given to all people who dig using UK Power Networks plan and symbols.
 7. Please be aware that electric cables/lines belonging to other owners of licensed electricity supply are not shown on this plan.
 8. Please be aware that Low Voltage Overhead power lines are not currently displayed for the Eastern Region via this service; if you require records on the location of these please contact our Plan Provision team directly via plans@unearthedbridging.co.uk.

The quality and accuracy of any print will depend on your printer, your computer and its print settings. Measurements scaled from this plan may not match measurements between the same points on the ground.

1. UK Power Networks does not warrant that the information provided to you is correct. You rely upon it at your own risk. UK Power Networks does not exclude or limit its liability if it causes the death of any person or causes personal injury to a person.
 2. UK Power Networks does not accept any liability for any loss of data, loss of information, loss of business, loss of profits, loss of revenue, loss of opportunity, loss of income, loss of interest, loss of reputation, loss of goodwill, loss of business, loss of use) or any special or consequential loss or damage whatsoever.
 3. This plan has been provided to you on the basis of the terms of use set out in the covering letter that accompanies this plan and must be returned to the sender of this letter.
 4. This plan is provided to you on the basis of the terms of use set out in the covering letter that accompanies this plan and must be returned to the sender of this letter.
 5. This plan is provided to you on the basis of the terms of use set out in the covering letter that accompanies this plan and must be returned to the sender of this letter.
 6. Please Note: This Overview map does not display UK Power Networks electricity network and should not be used for navigation or other purposes. For details of the electricity network, please view the relevant page or pages highlighted in the Overview map.

IF IN DOUBT - ASK PHONE
 EMERGENCY 0800 056 586
 For all other enquiries call our Customer Care Centre on 0800 783 8838 (24hrs)
 URGENTLY

ALWAYS LOOK UP BEFORE YOU DIG!
 Refer to ISE Guidance note G56

Also produced at 1:2500 scale are GeoSchematics which show LV mains cables and overhead lines (in some cases all voltages). Prior to carrying out excavations you must refer to the 1:500 records to determine the location of all known underground plant and equipment.

UK Power Networks

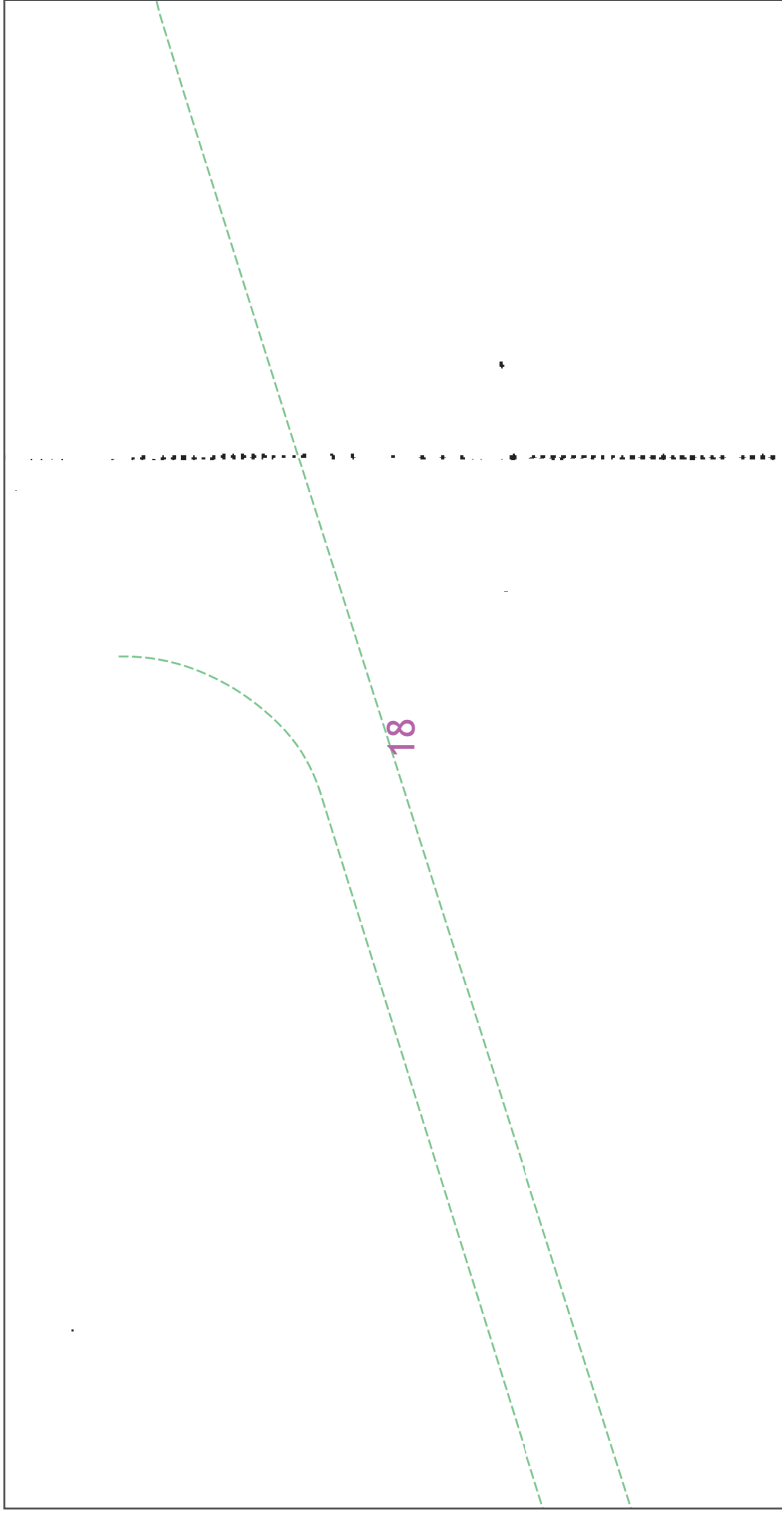

0 1.25 2.5 metres

This plan must be used with the attached 'Symbols' document.

Date Requested: 23/07/2021
 Job Reference: 22778282
 Site Location: 517403_204375
 Requested by: Mrs Amy Helford
 Your Scheme /Reference: 26728
 Scale: 1:500 (When plotted at A4)

The quality and accuracy of any print will depend on your printer, your computer and its print settings. Measurements scaled from this plan may not match measurements between the same points on the ground.

1. UK Power Networks does not warrant that the information provided to you is correct. You rely upon it at your own risk. UK Power Networks does not exclude or limit its liability if it causes the death of any persons or causes personal injury to a person.

2. This plan is provided to you as an advisory only. It is not intended to be used as a basis for any legal proceedings or for any other purpose. It is not intended to be used as a basis for any other purpose.

3. This plan is provided to you as an advisory only. It is not intended to be used as a basis for any legal proceedings or for any other purpose. It is not intended to be used as a basis for any other purpose.

4. It must be assumed that there is a service cable into each property, lamp column and street sign.

5. All cables must be treated as being live unless proved otherwise by UK Power Networks.

6. The information provided must be given to all people working near UK Power Networks plant and equipment.

7. Please be aware that electric cables/lines belonging to other owners of licensed electricity supply are not shown on this plan.

8. Please be aware that Low Voltage overhead power lines are not currently displayed for the Eastern Region via this service; if you require records on the location of these please contact our Plan Production team directly via plans@powernetworks.co.uk.

1. UK Power Networks does not exclude or limit its liability if it causes the death of any persons or causes personal injury to a person.

2. This plan is provided to you as an advisory only. It is not intended to be used as a basis for any legal proceedings or for any other purpose. It is not intended to be used as a basis for any other purpose.

3. This plan is provided to you as an advisory only. It is not intended to be used as a basis for any legal proceedings or for any other purpose. It is not intended to be used as a basis for any other purpose.

4. It must be assumed that there is a service cable into each property, lamp column and street sign.

5. All cables must be treated as being live unless proved otherwise by UK Power Networks.

6. The information provided must be given to all people working near UK Power Networks plant and equipment.

7. Please be aware that electric cables/lines belonging to other owners of licensed electricity supply are not shown on this plan.

8. Please be aware that Low Voltage overhead power lines are not currently displayed for the Eastern Region via this service; if you require records on the location of these please contact our Plan Production team directly via plans@powernetworks.co.uk.

6. Please Note: This Overview map does not display UK Power Networks electricity network and should not be used for excavation purposes. For details of the electricity network, please view the relevant page or pages of the relevant Distribution System Plan (DSP).

7. Also produced at 1:2500 scale are GeoSchematics which show LV mains cables and overhead lines (in some cases all voltages). Prior to carrying out excavations you must refer to the 1:500 records to determine the location of all known underground plant and equipment.

Reproduced by permission of Ordnance Survey on behalf of HMASO. © Crown copyright and database right, 2020. All rights reserved. Ordnance Survey Licence numbers 100019626, 100019626 and 100019450. Data has been added to the Ordnance Survey base map. All proprietary rights in such additional data are and shall remain the exclusive property of © London Power Networks plc or Eastern Power Networks plc or South Eastern Power Networks plc, each being a distribution licensee under section 6(1)(c) of the Electricity Act 1989 for the relevant distribution service area as that term is defined in such licensee's distribution licence. All rights in such data reserved.

Plans generated by digMAP Pro™ software provided by Unearthcloud Ltd.



IF IN DOUBT - ASK PHONE
 EMERGENCY 0800 054 5865
 For any damage a
 call on 0800 054 5865
 Phone 0800 783 8838 (24hrs)
 URGENTLY

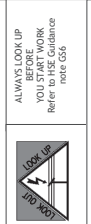

ALWAYS LOOK UP
 BEFORE
 DIGGING
 Refer to HSE Guidance
 note G56

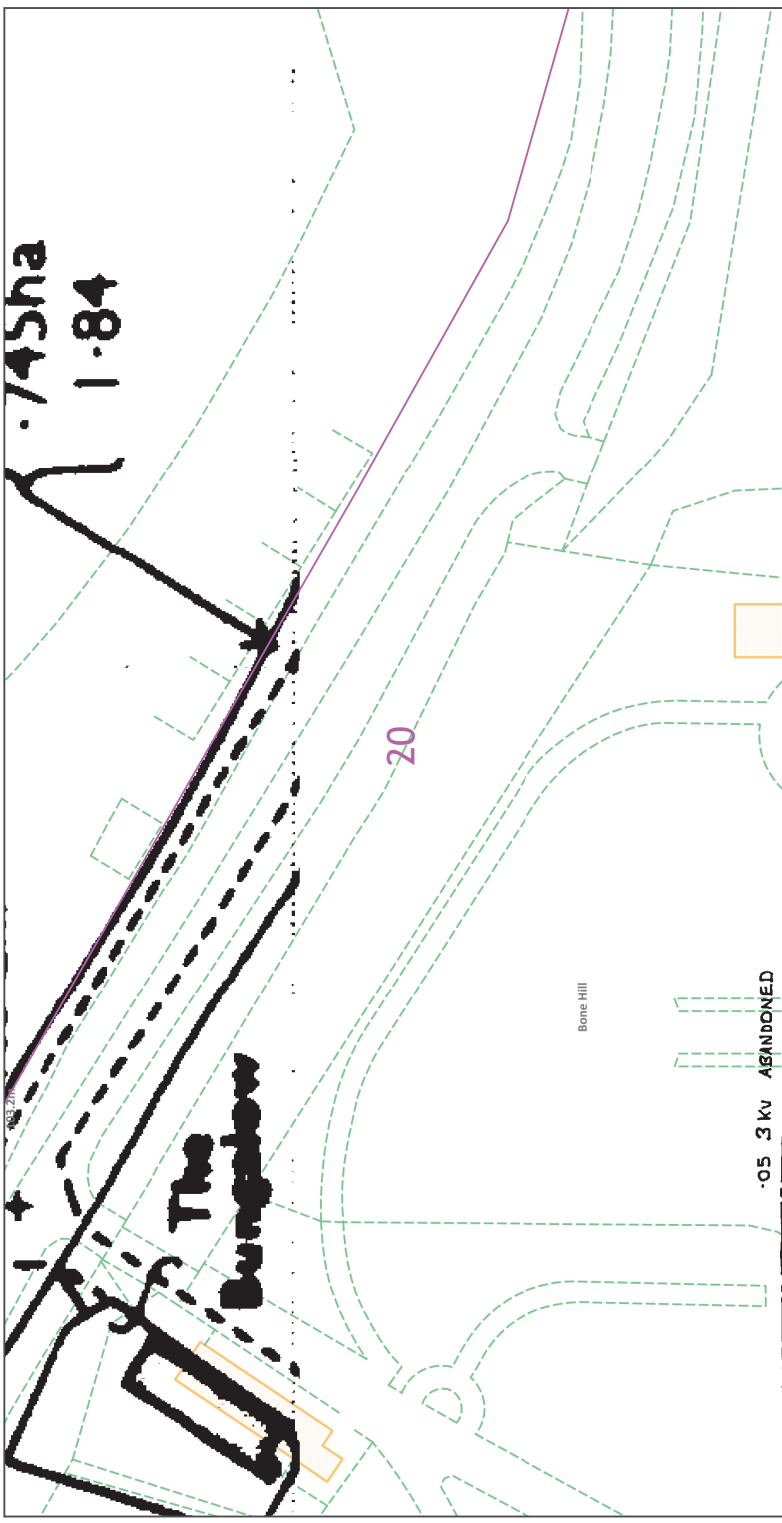

This plan must be used with the attached 'Symbols' document.

Date Requested: 23/07/2021
 Job Reference: 22778282
 Site Location: 517403 204375
 Requested by: Mrs Amy Helford
 Your Scheme/Reference: 26728
 Scale: 1:500 (When plotted at A4)

Reproduced by permission of Ordnance Survey on behalf of HMSO. © Crown copyright and database right, 2020. All rights reserved. Ordnance Survey Licence numbers 100019626, 100019626 and 100019450. Data has been added to the Ordnance Survey base map. All proprietary rights in such additional data are and shall remain the exclusive property of © London Power Networks plc or Eastern Power Networks plc, each being a distribution licensee under section 6(1)(c) of the Electricity Act 1989 for the relevant distribution service area as that term is defined in such licensee's distribution licence. All rights in such data reserved.
 Plans generated by digMATE Pro™ software provided by Unesaarchloridbldg.

1. The position of the apparatus shown on this drawing is believed to be correct but the original line marks may have been altered since the apparatus was installed.
 2. The information provided must be given to all people who dig near UK Power Networks plant and equipment to excavation using suitable hand tools.
 3. It must be assumed that there is a service cable into each property, lamp column and street sign, until the exact location of all the cables have been determined.
 4. It must be assumed that there is a service cable into each property, lamp column and street sign.
 5. All cables must be treated as being live unless proved otherwise by UK Power Networks.
 6. The information provided must be given to all people who dig near UK Power Networks plant and equipment to excavation using suitable hand tools.
 7. Please be aware that electric cables/wires belonging to other owners of licensed electricity supply are shown on this plan and must be treated as live.
 8. Please be aware the Low Voltage Overhead power lines are not currently displayed for the Eastern Region via this service; if you require records on the location of these please contact our Plan Provision team directly via plans@powernetworks.co.uk.

The quality and accuracy of any print will depend on your printer, your computer and its print settings. Measurements scaled from this plan may not match measurements between the same points on the ground.

1. UK Power Networks does not warrant that the information provided to you is correct. You rely upon it at your own risk. UK Power Networks does not exclude or limit its liability if it causes the death of any persons or causes personal injury to a person.
 2. UK Power Networks does not warrant that the information provided to you is correct. You rely upon it at your own risk. UK Power Networks does not exclude or limit its liability if it causes the death of any persons or causes personal injury to a person.
 3. UK Power Networks does not warrant that the information provided to you is correct. You rely upon it at your own risk. UK Power Networks does not exclude or limit its liability if it causes the death of any persons or causes personal injury to a person.
 4. This plan has been provided to you on the basis of the terms of use set out in the covering letter that accompanies this plan and must return it to the sender of the letter.
 5. UK Power Networks does not warrant that the information provided to you is correct. You rely upon it at your own risk. UK Power Networks does not exclude or limit its liability if it causes the death of any persons or causes personal injury to a person.
 6. Please Note: This Overview map does not display UK Power Networks electricity network and should not be used for excavation or other work for any loss, damage, cost, claim, demands, or expenses that you or any third party may suffer or incur as a result of using the information provided whether for physical damage to property or for any economic loss or any special or consequential loss or damage whatsoever.
 7. Please be aware that electric cables/wires belonging to other owners of licensed electricity supply are shown on this plan and must be treated as live.
 8. Please be aware the Low Voltage Overhead power lines are not currently displayed for the Eastern Region via this service; if you require records on the location of these please contact our Plan Provision team directly via plans@powernetworks.co.uk.

IF IN DOUBT - ASK PHONE
 EMERGENCY CALLS
 Phone 0800 783 8838 (24hrs)
 URGENTLY

ALWAYS LOOK UP BEFORE YOU DIG
 Refer to HSE Guidance note G56

UK Power Networks

0 1.2.5 metres

2.5

05 3 kV ABANDONED

Dig Sites Area: Line:



0 1.2.5 metres

2.5

05 3 kV ABANDONED

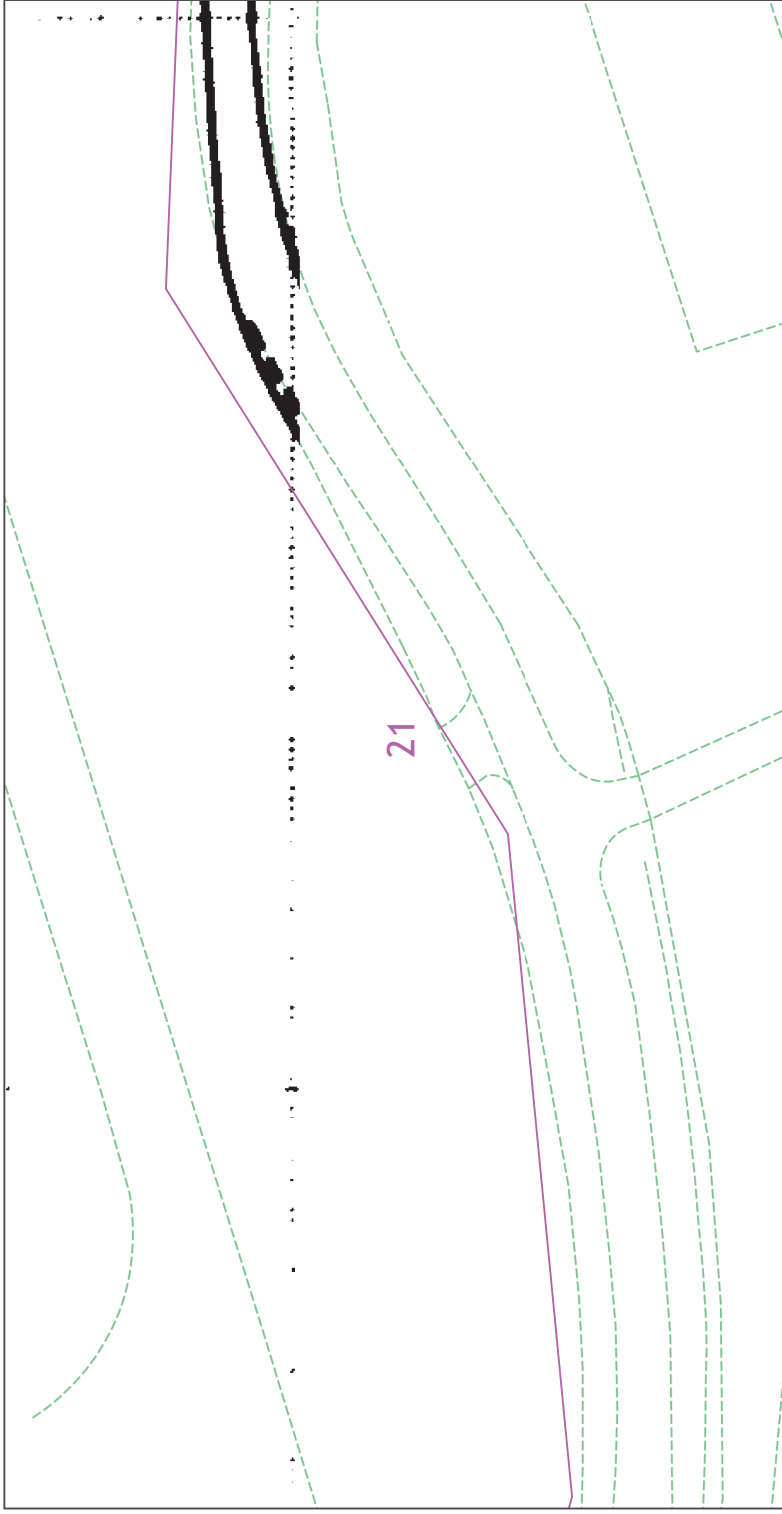
Dig Sites Area: Line:



		<p>The quality and accuracy of any print will depend on your printer, your computer and its print settings. Measurements scaled from this plan may not match measurements between the same points on the ground.</p>
	<p>IF IN DOUBT - ASK PHONE 0800 054 586 or call our call centre on 0800 783 8838 (24hrs) URGENTLY</p>	<p>1. UK Power Networks does not warrant that the information provided to you is correct. You rely upon it at your own risk. UK Power Networks does not exclude or limit its liability if it causes the death of any persons or causes personal injury to a person.</p> <p>2. UK Power Networks does not accept any liability for any loss of data, loss of business, loss of profits, loss of opportunity, loss of revenue, loss of contracts, loss of goodwill, loss of savings, loss of earnings, loss of business, loss of use of any or any special or consequential loss or damage whatsoever.</p> <p>3. This plan has been provided to you on the basis of the terms of the service set out in the covering letter that accompanies this plan and must be returned to the sender of this letter.</p> <p>4. This plan has been provided to you on the basis of the terms of the service set out in the covering letter that accompanies this plan and must be returned to the sender of this letter.</p> <p>5. All cables must be treated as being a service cable into each property, lamp column and street sign, until the exact location of all the cables have been determined.</p> <p>6. The information provided must be given to all people working on the site. UK Power Networks plan and site location information is provided to you for your information only. It is not to be used for any other purpose.</p> <p>7. Please be aware that electric cables/lines belonging to other owners of licensed electricity supply are not shown on this plan. If you are aware of any such cables/lines, please contact the relevant owner.</p> <p>8. Please be aware that Low Voltage Overhead power lines are not currently displayed for the Eastern Region via this service. If you require records on the location of these please contact our Plan Production team directly via plans@powernetworks.co.uk.</p>
<p>ALWAYS LOOK UP BEFORE YOU DIG Refer to the Guidance note G56</p>	<p>Also produced at 1:500 scale are GeoSchematics which show LV mains cables and overhead lines (in some cases all voltages). Prior to carrying out excavations you must refer to the 1:500 records to determine the location of all known underground plant and equipment.</p>	<p>1. UK Power Networks does not warrant that the information provided to you is correct. You rely upon it at your own risk. UK Power Networks does not exclude or limit its liability if it causes the death of any persons or causes personal injury to a person.</p> <p>2. UK Power Networks does not accept any liability for any loss of data, loss of business, loss of profits, loss of opportunity, loss of revenue, loss of contracts, loss of goodwill, loss of savings, loss of earnings, loss of business, loss of use of any or any special or consequential loss or damage whatsoever.</p> <p>3. This plan has been provided to you on the basis of the terms of the service set out in the covering letter that accompanies this plan and must be returned to the sender of this letter.</p> <p>4. This plan has been provided to you on the basis of the terms of the service set out in the covering letter that accompanies this plan and must be returned to the sender of this letter.</p> <p>5. All cables must be treated as being a service cable into each property, lamp column and street sign, until the exact location of all the cables have been determined.</p> <p>6. The information provided must be given to all people working on the site. UK Power Networks plan and site location information is provided to you for your information only. It is not to be used for any other purpose.</p> <p>7. Please be aware that electric cables/lines belonging to other owners of licensed electricity supply are not shown on this plan. If you are aware of any such cables/lines, please contact the relevant owner.</p> <p>8. Please be aware that Low Voltage Overhead power lines are not currently displayed for the Eastern Region via this service. If you require records on the location of these please contact our Plan Production team directly via plans@powernetworks.co.uk.</p>

This plan must be used with the attached 'Symbols' document.

Date Requested: 23/07/2021
Job Reference: 22778282
Site Location: 517403_204375
Requested by: Mrs Amy Helford
Your Scheme/Reference: 26728
Scale: 1:500 (When plotted at A4)

Reproduced by permission of Ordnance Survey on behalf of HMSO. © Crown copyright and database right. 2020. All rights reserved. Ordnance Survey Licence numbers 100079626, 100019626 and 100019450. Data has been added to the Ordnance Survey base map. All proprietary rights in such additional data are and shall remain the exclusive property of © London Power Networks plc or South Eastern Power Networks plc, each being a distribution licensee under section 6(1)(c) of the Electricity Act 1989 for the relevant distribution service area as that term is defined in such licensee's distribution licence. All rights in such data reserved.

Plans generated by digSAFE Pro™ software provided by lineascholarholding.com.