

Tree Preservation Order

Town and Country Planning Act 1990

The St Albans City and District Council Tree Preservation Order No 1539 31 January 2013, Woodland adjacent to Woodside Road and Five Acres Country Club, Bricket Wood, St Albans

The St Albans City and District Council, in exercise of the powers conferred on them by section 198 of the Town and Country Planning Act 1990 make the following Order—

Citation

1. This Order may be cited as TPO 1539, Woodland adjacent to Woodside Road and Five Acres Country Club, Bricket Wood, St Albans 2013.

Interpretation

2.— (1) In this Order “the authority” means the St Albans City and District Council.
(2) In this Order any reference to a numbered section is a reference to the section so numbered in the Town and Country Planning Act 1990 and any reference to a numbered regulation is a reference to the regulation so numbered in the Town and Country Planning (Tree Preservation)(England) Regulations 2013.

Effect

3.— (1) Subject to article 4, this Order takes effect provisionally on the date on which it is made.

(2) Without prejudice to subsection (7) of section 198 (power to make tree preservation orders) or subsection (1) of section 200 (tree preservation orders: Forestry Commissioners) and, subject to the exceptions in regulation 14, no person shall—

(a) cut down, top, lop, uproot, wilfully damage, or wilfully destroy; or

(b) cause or permit the cutting down, topping, lopping, uprooting, wilful damage or wilful destruction of,

any tree specified in the Schedule to this Order except with the written consent of the authority in accordance with regulations 16 and 17, or of the Secretary of State in accordance with regulation 23, and, where such consent is given subject to conditions, in accordance with those conditions.

Application to trees to be planted pursuant to a condition

4. In relation to any tree identified in the first column of the Schedule by the letter “C”, being a tree to be planted pursuant to a condition imposed under paragraph (a) of section 197 (planning permission to include appropriate provision for preservation and planting of trees), this Order takes effect as from the time when the tree is planted.

Dated this day 31 of JANUARY 2013

[Signed on behalf of the St Albans City and District Council

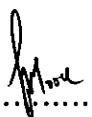
.....

Authorised by the Council to sign in that behalf]

CONFIRMATION OF ORDER
St Albans City and District Council

[This Order was confirmed by ~~insert name of Council~~ without modification on the 30th day of
July 2013

OR

~~[This Order was confirmed by the St Albans City and District Council, subject to the
modifications indicated by _____, on the _____ day of
2013]~~

[Signed on behalf of the St Albans City and District Council

.....

Authorised by the Council to sign in that behalf]

[DECISION NOT TO CONFIRM ORDER

[A decision not to confirm this Order was taken by St Albans City and District Council on the
day of _____ 2013

[Signed on behalf of the St Albans City and District Council

.....

Authorised by the Council to sign in that behalf]

[VARIATION OF ORDER

[This Order was varied by the St Albans City and District Council on the _____ day of
2013 by a variation order under reference number *[insert reference
number to the variation order]* a copy of which is attached]

[Signed on behalf of the St Albans City and District Council

.....

Authorised by the Council to sign in that behalf]

[REVOCATION OF ORDER

[This Order was revoked by the St Albans City and District Council on the _____ day of
2013

[Signed on behalf of the St Albans City and District Council

.....

Authorised by the Council to sign in that behalf]

SCHEDULE
SPECIFICATION OF TREES

Trees specified individually
(encircled in black on the map)

Reference on map	Description	Situation
None		

Trees specified by reference to an area
(within a dotted black line on the map)

Reference on map	Description	Situation
None		

Groups of trees
(within a broken black line on the map)

Reference on map	Description	Situation
None		

Woodlands
(within a continuous black line on the map)

Reference on map	Description	Situation
W1	Mixed deciduous including mainly Hornbeam, Cherry, Birch, Field Maple, Oak, Hazel and Holly	

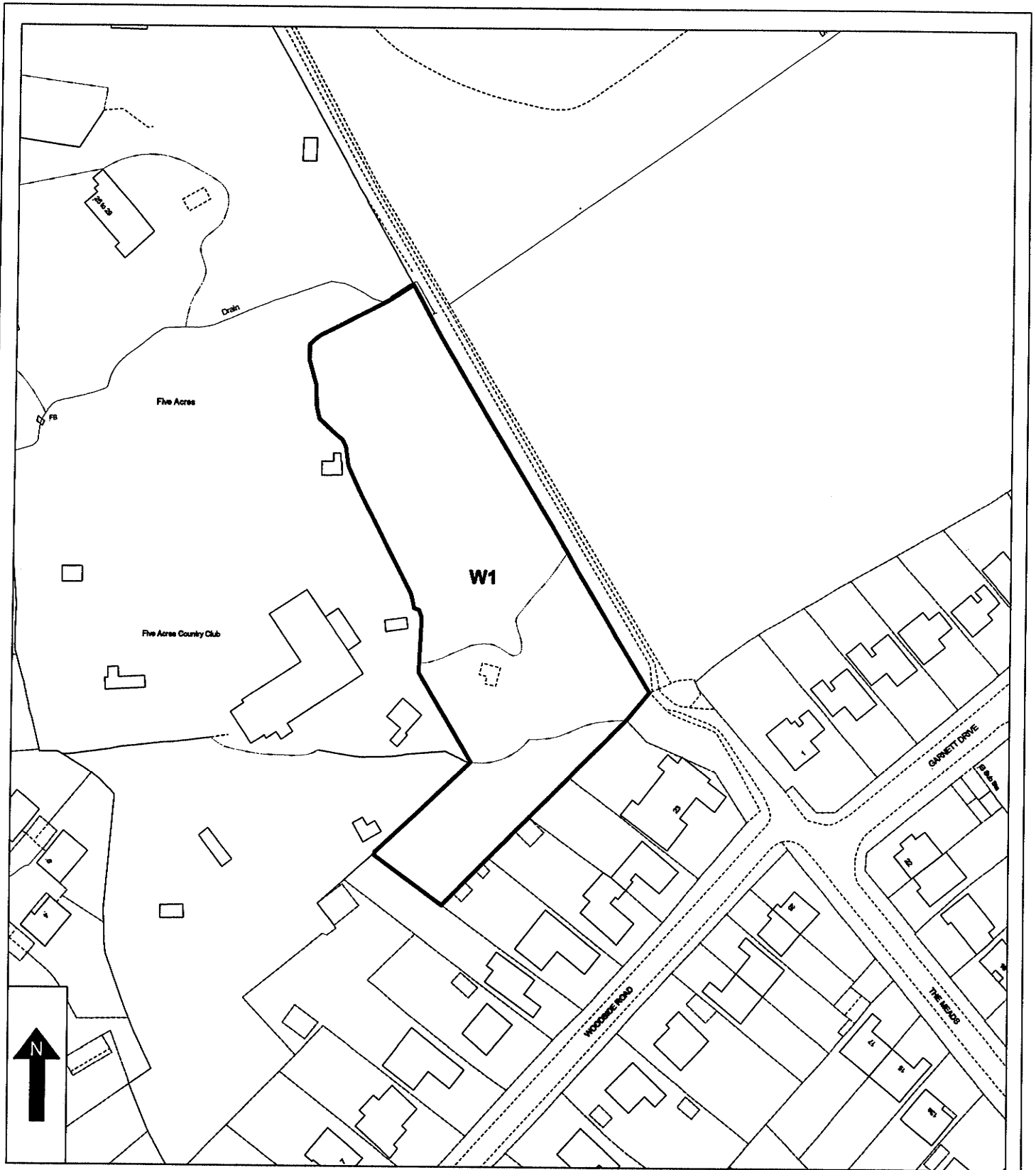

Location: Woodland adjacent to Woodside Road and Five Acres Country Club, Bricket Wood, St Albans.

Schedule: Tree Preservation Order No.1539

Individual Trees: None

Groups: None

Areas: None

Woodlands: W1, Mixed deciduous including mainly Hornbeam, Cherry, Birch, Field Maple, Oak, Hazel and Holly.



Dated this 31 January 2013

Authorised by the Council to sign in that behalf

© Crown copyright and database rights
2013 Ordnance Survey 100018953

Scale:- 1:1250

Drawn By AD

Date 31 January 2013